

NOTES: UNLESS OTHERWISE SPECIFIED

1. SEE DRAWING NO. CB-00290 AND PROCEDURE P-1000 FOR ASSEMBLY AND TEST INSTRUCTION. PROCEDURES AND ASSEMBLY DRAWINGS ARE FOR INTERNAL USE ONLY.
2. ALL TESTING IS PERFORMED IAW BATTERY COUNCIL INTERNATIONAL STANDARDS.
3. ALL DIMENSIONS ARE INCH [MM]

REVISIONS			
REV	DESCRIPTION	DATE	APPROVED
A	REDESIGNED COVER	1/24/18	PH

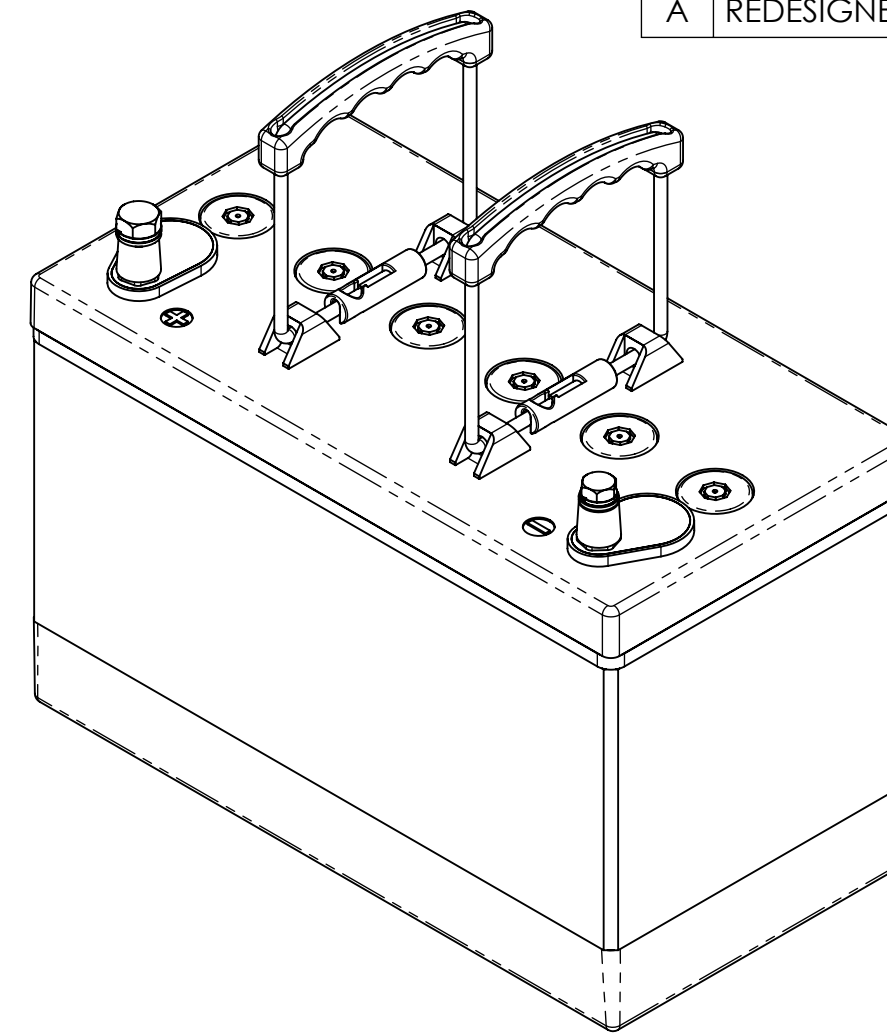
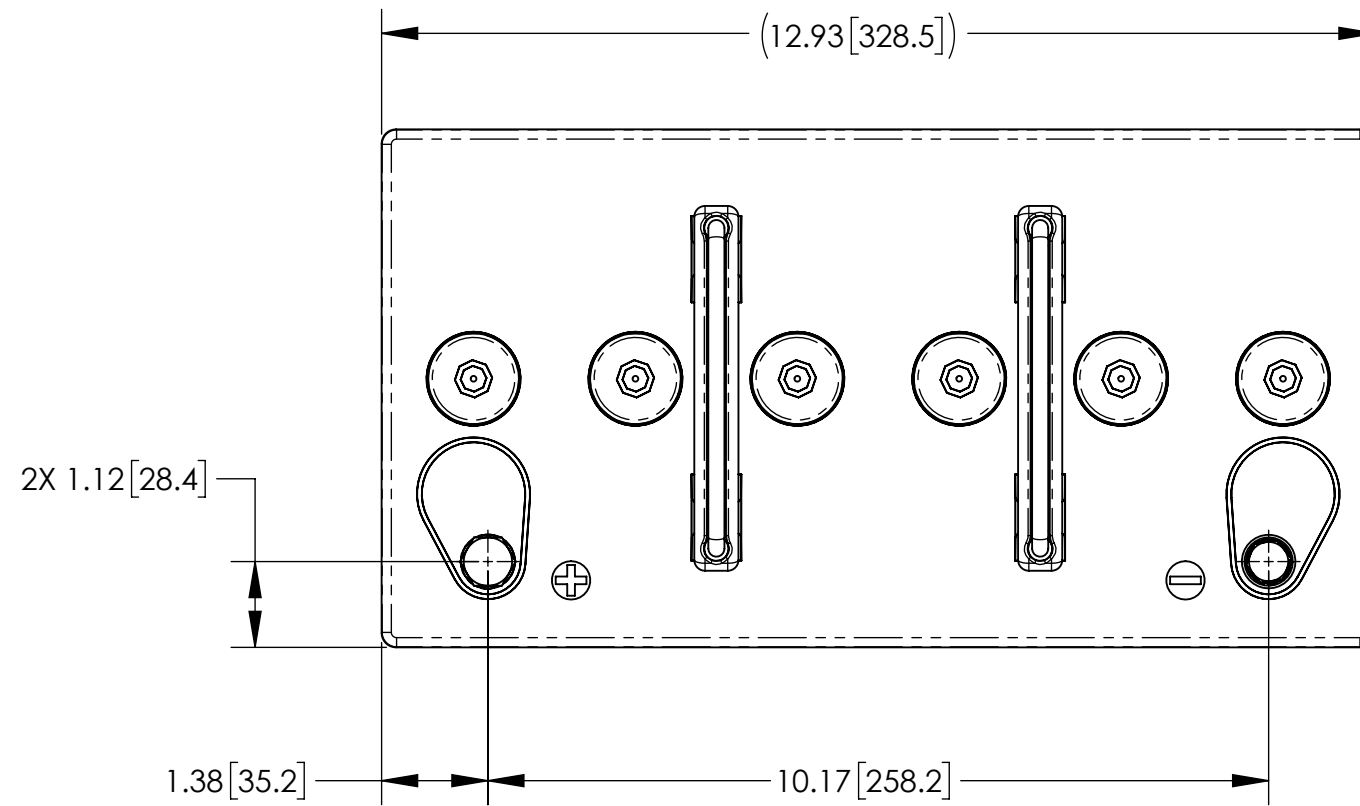

ISOMETRIC VIEW

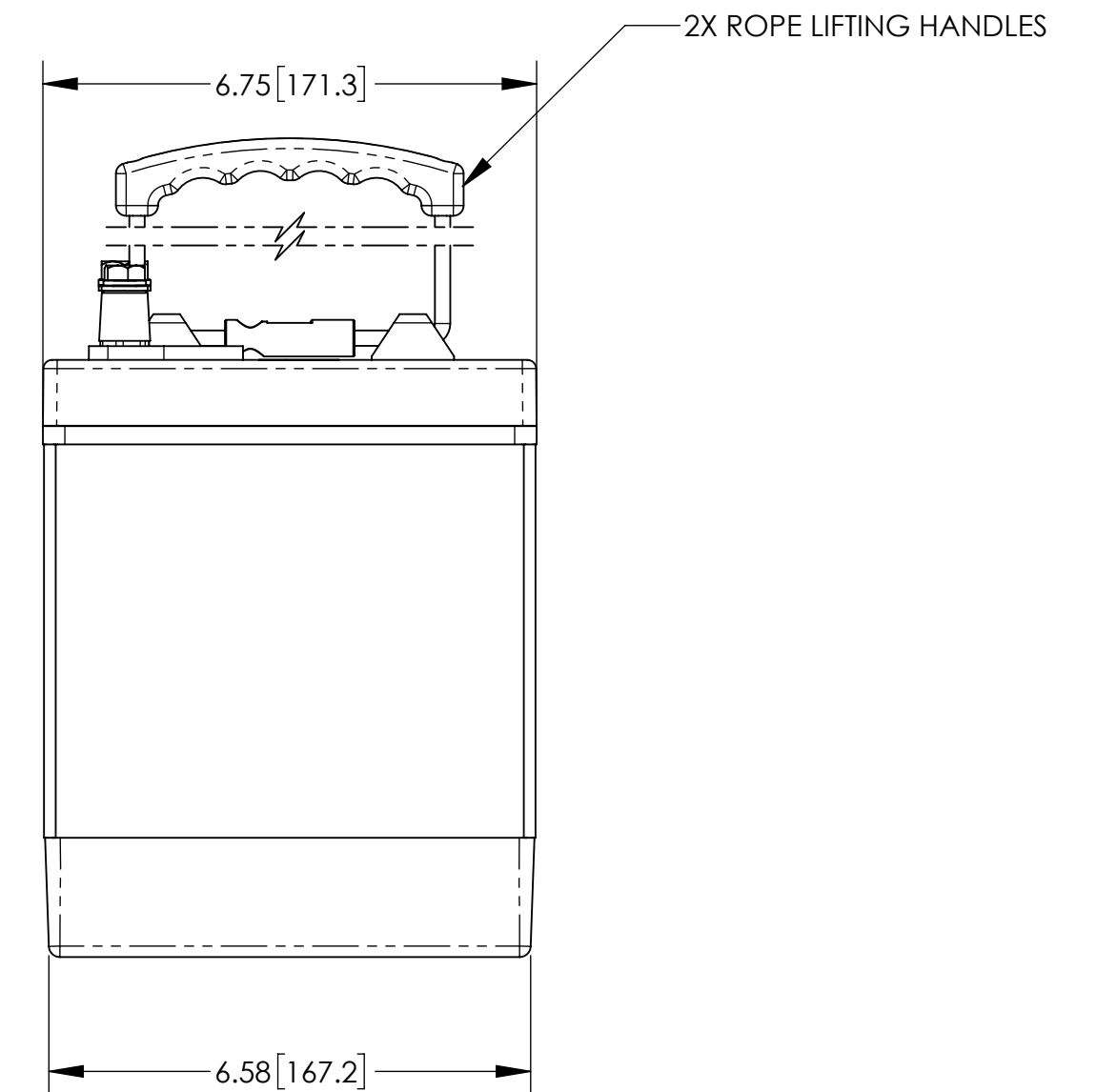
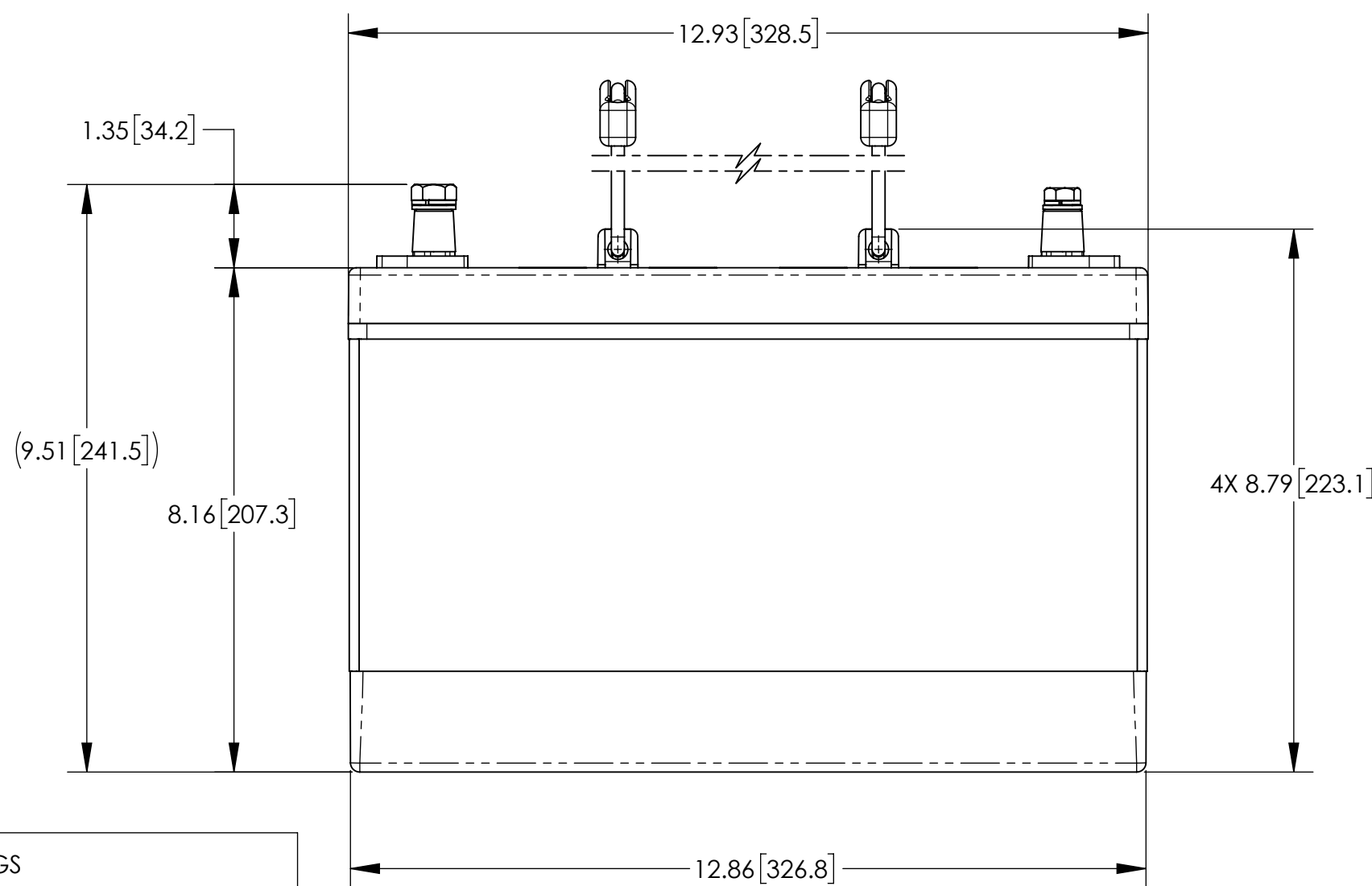

CAPACITY RATINGS	
PART NUMBER	GPL-3100T
NOMINAL WEIGHT	67 LBS [30.4 KG]
AMPERE HOUR CAPACITY @ 20 HOUR 1.75 VOLTS/CELL @ 77°F (25°C)	100 AH
MINUTES OF DISCHARGE @ 25 AMPS 1.75 VOLTS/CELL @ 77°F (25°C)	228 MIN
COLD CRANKING AMPS @ 68°F	1120
COLD CRANKING AMPS @ 32°F	950
COLD CRANKING AMPS @ 0°F	810

ENVELOPE DRAWING

UNLESS OTHERWISE SPECIFIED DIMENSIONS ARE IN INCHES TOLERANCES ARE:			CONTRACT NO.		CONCORDE BATTERY CORPORATION 2009 SAN BERNARDINO RD, W. COVINA, CA 91790		
FRACTIONS	DECIMALS	ANGLES	APPROVALS	DATE	TITLE		
±1/32	.XX ± .06 .XXX ± .060	±1°	DRAWN S. FRAZIER	5/7/02	BATTERY, 12 VOLT, GPL-3100T		
TREATMENT	NONE	CHECKED HRF	5/14/02	SIZE C	CAGE CODE 63017	DWG NO. GPL-3100T	REV A
FINISH	NONE	APPROVED JBT	5/17/02	SCALE 1:2.5	SHEET 1 OF 1		
SIMILAR TO	CALC WT	ISSUED JG	1/25/18				